

## JACKUP MOUNTS Series DJM

**Dynemech**  
VIBRATION TECHNOLOGY

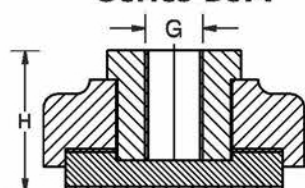

**Series-DJM**



Adapter with M20x2.5 Inner Thread  
and M40x2 External Thread

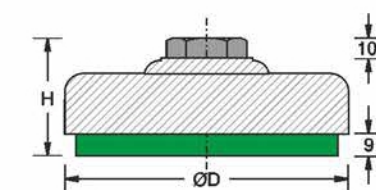

Bolt-through  
25mm diameter bore

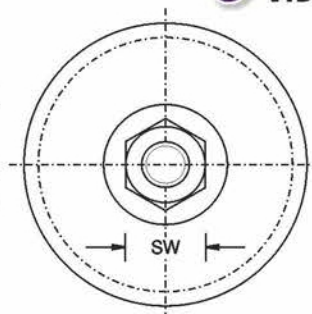

Leveling socket  
with anti-skid pad

### Leveling Sockets

The levelling sockets are provided for many possible types of installations as per customers requirement.

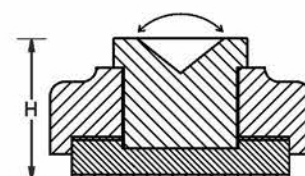

Countersink as per customer  
requirement and bolt profile

Dynemech Jackup Mounts provides isolation solutions for various machines and mounting conditions. The Dynemech Jackup Mounts also provide for high machine leveling capabilities. These Jackup mounts provide high load capacity and best level stability. The bottom design provides for non-skid properties for the Jackup Mount. The Jackup mount also provide very good passive vibration isolation.

**Applications :** Machine Tools, Textile Machine, Graphics machines, Planners long bedded machines etc.

Model	Load (Kg/pc)	Height H (mm)	Dia D (mm)	G (mm)	HEX SW (mm)	Levelling Adjustment (mm)
DJM-0	850	49	90	M20 x 2.5 (Length 38mm)	46	18
DJM-1	1500	49	120	M20 x 2.5 (Length 38mm)	46	18
DJM-2	2500	49	160	M20 x 2.5 (Length 38mm)	62	18

Note: Please mention type of socket required at the time of ordering.

## LEVEL GRIP MOUNTS Series DRM

**DRM1-150-S2**

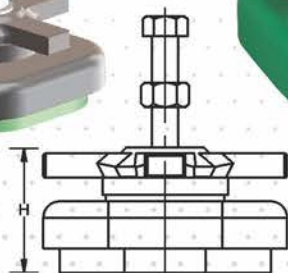
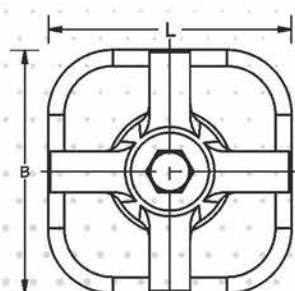

**DRM1-232-S2**

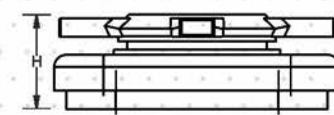
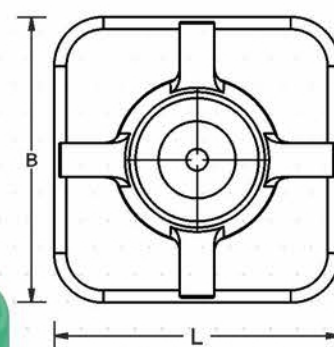

DRM mounts levelling is done using a large lever screw. This screw transmits static and dynamic load of the machine on a larger area and thus provides greater stability to the machine. The levelling lever requires lesser torque for lifting the machine while levelling.

S. No.	Model	Load (Kg/pc)	Length L (mm)	Width B (mm)	Height H (mm)	Levelling Adjustment (mm)
1.	DRM1-150-S2	1000	150	150	77	20
2.	DRM1-232-S2	3300	232	232	77	20